

GENERAL NOTES

1. ALL DIMENSIONS & SITE CONDITIONS ARE TO BE CONFIRMED ON SITE BY THE CONTRACTOR. THE CONTRACTOR IS RESPONSIBLE TO SORT THE SITE PRIOR TO SUBMITTING A TENDER. MAKE SURE YOU UNDERSTAND THE CONDITIONS THAT MAY AFFECT THE WORK.

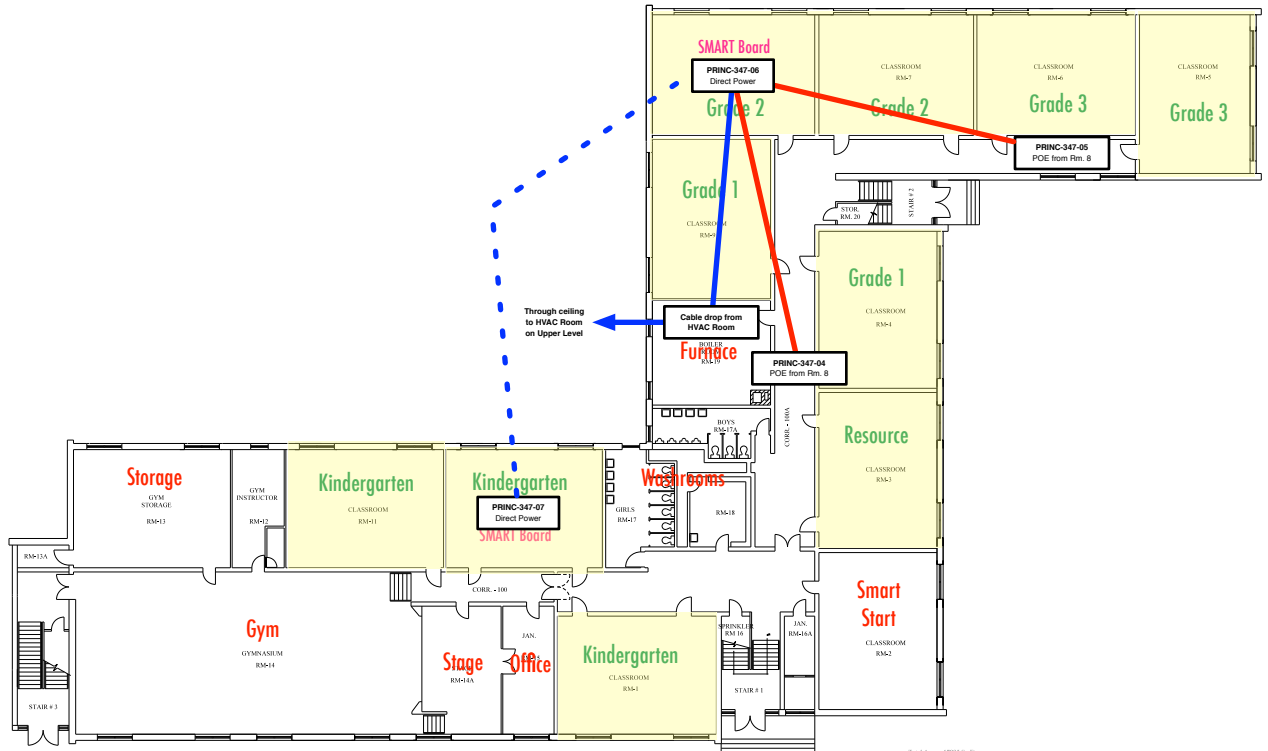

LOWER LEVEL
SCALE = 1/320

Total Area = 4700 Sq.Ft.

PRELIMINARY NOT FOR CONSTRUCTION	
	Transportation and Infrastructure Renewal
PS Box 2000 Tel: 902 368 3100 Fax: 902 369 3599 http://www.gov.pe.ca/	Charlottetown Prince Edward Island Canada C1A 7N8
	A = Detail # BB = Sheet # (Where Detail Required) CC = Sheet # (Where Detailed)
Project Title: Prince Street Elementary	
Drawing Title: Lower Floor Plan	
Scale: 1/320	Design By: .
Drawn By: .	Date: January 2011
Project No.: 450 0000	Drawing #: A1 of 2

M7100-01-000

1/11/2011 10:25 AM PrinceStreetElementary.dwg C:\pwworking\princestreetelementary\princestreetelementary.dwg

GENERAL NOTES

1. ALL DIMENSIONS & SITE CONDITIONS ARE TO BE CONFIRMED ON SITE BY THE CONTRACTOR. CONTRACTOR IS RESPONSIBLE TO MEET THE SITE PRIOR TO COMMENCEMENT & MAKE THEMSELVES AWARE WITH CONDITIONS THAT MAY AFFECT THE WORK.

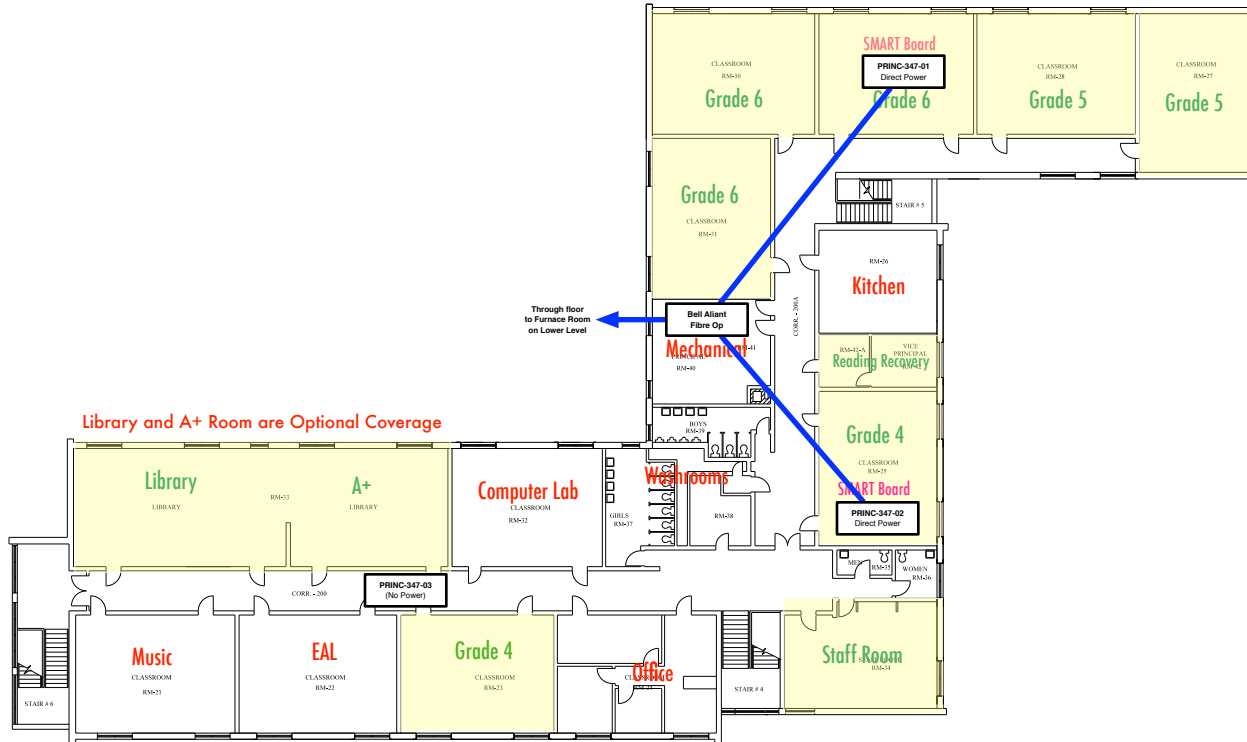

UPPER LEVEL
SCALE = 1/125

Total Area = 1780 Sq Ft.

PRELIMINARY
NOT FOR CONSTRUCTION

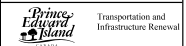

Transportation and Infrastructure Renewal
PO Box 3688
Tel: 902 368 5100 Charlottetown
Fax: 902 369 6598 Prince Edward Island
http://www.gov.pe.ca/ Canada C1A 7G4

A 2 Detail #
BB 8 Sheet # (Where Detail Required)
CC 8 Sheet # (Where Detailed)

Project Title:
Prince Street Elementary

Drawing Title:
Upper Floor Plan

Scale: 1/125 Design By: .
Drawn By: . Date: January 2011

Project No.: 450 0000 Drawing #: A2 of 2

METRIC 2010.AEC

11/11/2011
8:27:48 AM
C:\Users\jgibson\Documents\Projects\2010\20100101\20100101.dwg